

SEE PAGE 2 FOR  
TOOL-HOLDER  
DETAILS

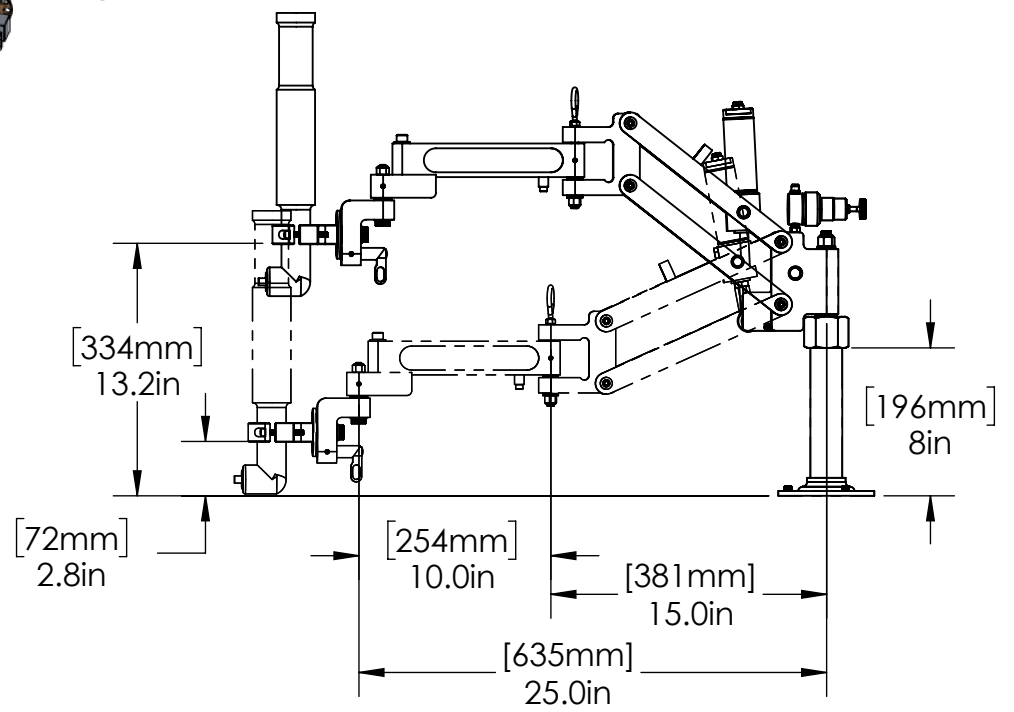

MODEL#: EL315-RAH
TOOL HOLDER RAH-TH INCLUDED
A shortened version of EL815-RAH with less reach for tighter spaces. For HORIZONTAL Fastening with customer's Right Angle Electric Tool
MAX TORQUE: 400 in-lbs (45 N-m)
MAX. TOOLING WEIGHT: 11.25 lbs (5.1 kg)
COPYRIGHT © 2018 ERGONOMIC TOOL ARMS, LLC

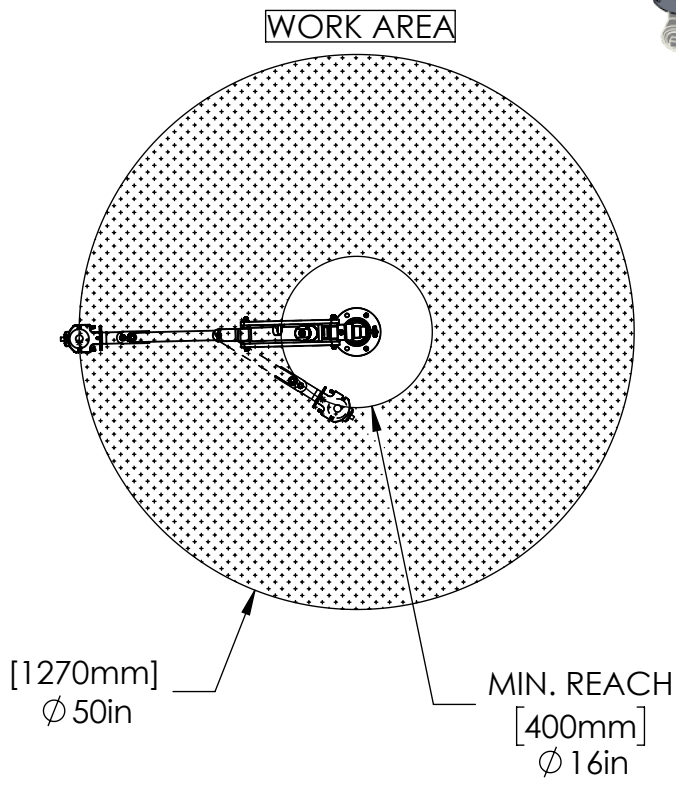

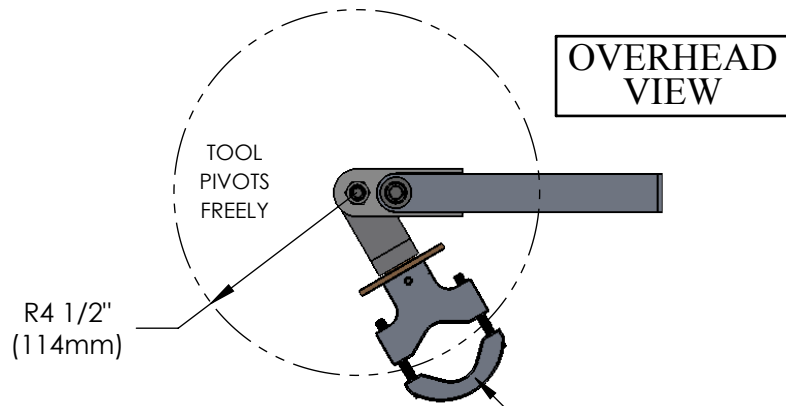

OVERHEAD VIEW

R4 1/2" (114mm)

TOOL PIVOTS FREELY

MINIMUM TOOL DIAMETER:  
1-1/8" (28.6mm)  
MAXIMUM TOOL DIAMETER:  
2.0" (50.8mm)

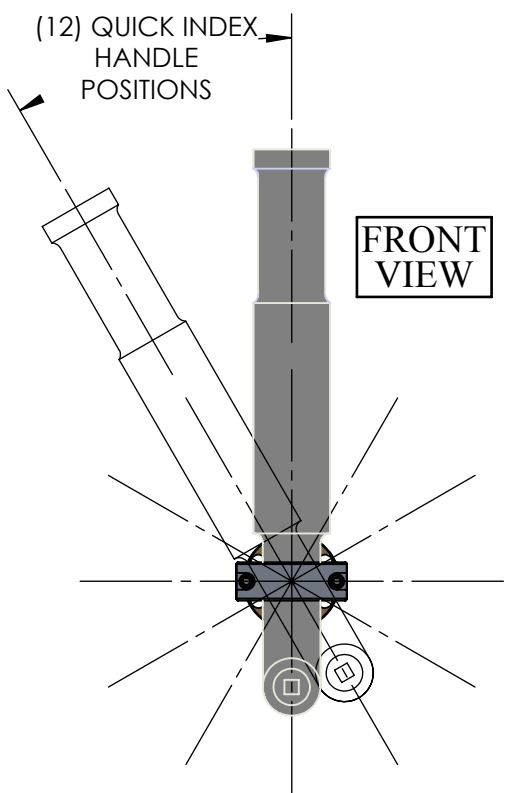

FRONT VIEW

(12) QUICK INDEX HANDLE POSITIONS

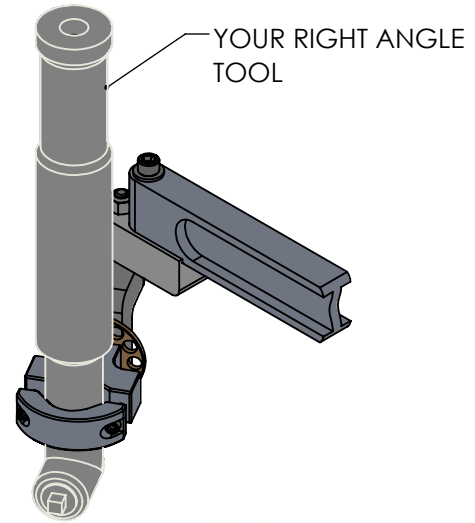

YOUR RIGHT ANGLE TOOL



SIDE VIEW

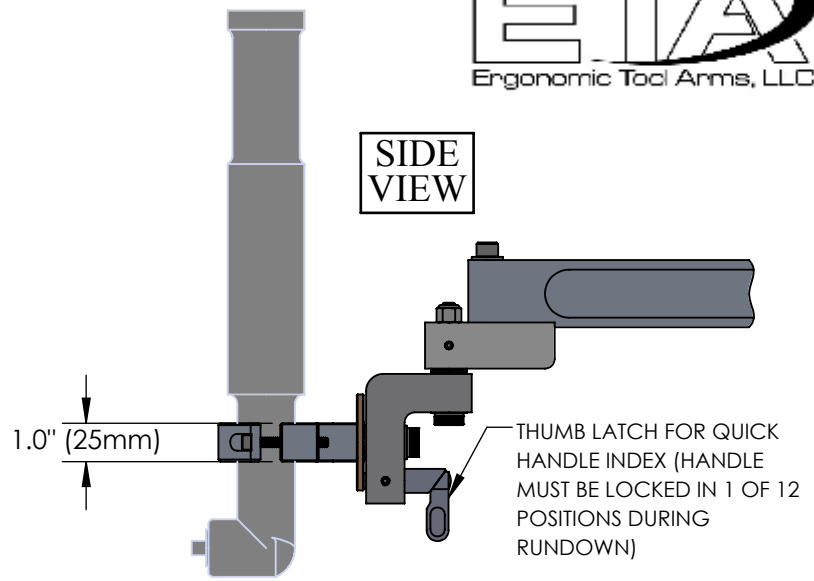

THUMB LATCH FOR QUICK HANDLE INDEX (HANDLE MUST BE LOCKED IN 1 OF 12 POSITIONS DURING RUNDOWN)

COPYRIGHT © 2017 ERGONOMIC TOOL ARMS, LLC

Model **RAH-TH**  
**Right Angle Horizontal Tool Holder**  
 FOR HORIZONTAL FASTENING

THIS DRAWING CONTAINS CONFIDENTIAL INFORMATION, IS THE PROPERTY OF ERGONOMIC TOOL ARMS, LLC AND IS GIVEN TO THE RECEIVER IN CONFIDENCE. THE RECEIVER BY RECEPTION AND RETENTION OF THIS DRAWING, ACCEPTS THE DRAWING IN CONFIDENCE AND AGREES THAT IT WILL NOT USE THE DRAWING OR A COPY THEREOF OR THE CONFIDENTIAL INFORMATION IT CONTAINS FOR THE PURPOSES OTHER THAN THAT INSTRUCTED BY ERGONOMIC TOOL ARMS, LLC, EITHER WRITTEN OR IMPLIED. THE RECEIVER AGREES, BY ACCEPTANCE AND RETENTION TO BE HELD LIABLE FOR MISUSE OF THIS DRAWING OR THE INFORMATION IT CONTAINS.